

रि

Mounting

V1.0



EN

Mounting accessories

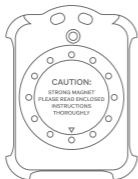

Magnetic mount Case



Magnetic mount clip

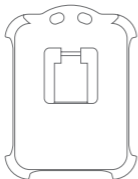

Multi-mount case

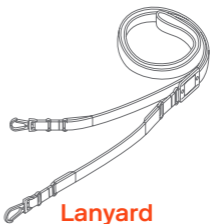

Lanyard



Click Fast stud

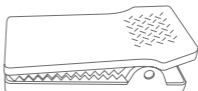

Crocodile clip

Mounting options

1. Magnet mount case and clip

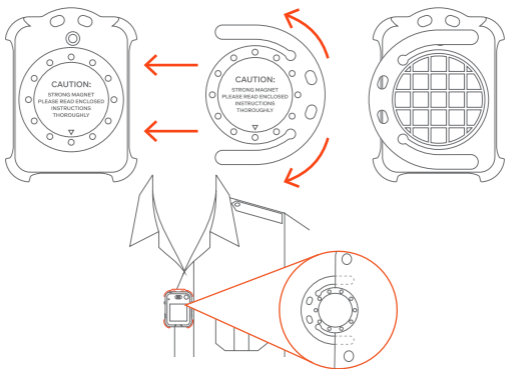

2. Lanyard with multi-mount case or magnetic mount clip

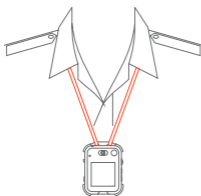

2a



2b

Wearable underneath clothing using magnet mount

Mounting options

3. Shirt clip with multi-mount case

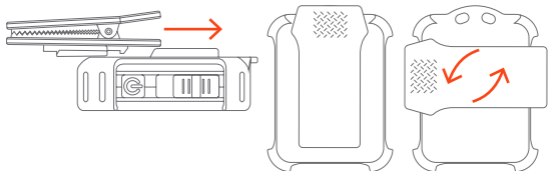

Shirt clip can be rotated

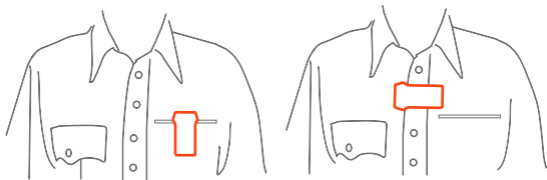

4. Klick Fast mounting

Klick Fast gives the user the option of where, and how, to carry their devices. Sliding the Klick Fast stud into any Klick Fast dock locks it securely in place. Once docked the camera can be rotated to different positions and it will remain held in place.

To remove, just rotate the camera to the inverted position and it slides free.

Mounting options

Attached Klick Fast stud to multi-mount case

The R1 camera is supplied with a small tool in the box to assist attachment and removal of the Klick Fast stud.

Simply align the tool with the Klick Fast stud and the groove on the back of the multi-mount case and push upward to click stud into place.

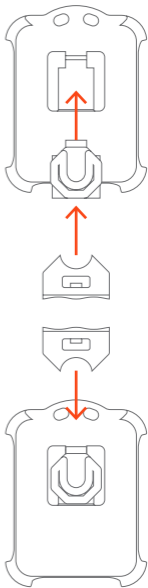

Remove Klick Fast stud to multi-mount case

The same tool can be used to remove the Klick Fast stud from the multi-mount case, this time placing the tool at the top and pushing downwards to release the stud.